

İZOLASYON ÇİVİSİ VE PULU

INSULATIN PINS AND CLIPS

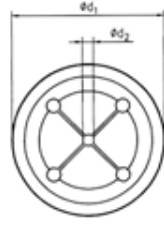

Pins:

d_1	Length
Dia. 2	20 - 100
Dia. 3	30 - 100

Material pin : Steel (4.8)
1.4301/03 on request)
Material clips : St2k70
galvanized, 1.4301/03 (A2-50)

Clips:

d_2	d_1	Length
St2k70 galvanized		
2	38	6-times
3		6-times
2		4-times
3		3-times
1.4301/03 (A2-50)		
2	30	6-times
2		4-times
3		3-times

Tavsiye Edilen Güç Üniteleri / Recommended power units :

CD 1501

Tavsiye Edilen Kaynak Tabancaları / Recommended welding guns:

C 08