

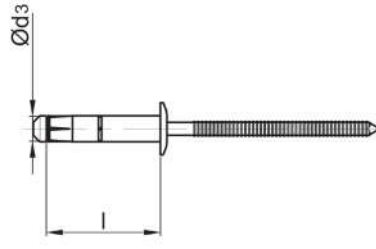



STELOCK PERÇİN ST-ST BOMBE KAFA

STELOCK RIVET ST-ST DOME HEAD

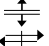
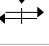
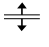

Çelik
Çinko Kaplama
Steel
Zinc Plated

Çelik
Çinko Kaplama
Steel
Zinc Plated

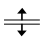
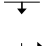
Ø d3	 [mm]		l [+1/-2] [mm]	 mm	ÜRÜN NO PART NO		
4,0 [+0.01]	Ø 4,1 - 4,2	 [N] : 285  [N] : 420	7,7	1,0 - 3,0	01.082211.40077		
			9,7	3,0 - 5,0	01.082211.40097		
			12,7	5,0 - 7,0	01.082211.40127		
4,8 [+0.01]	Ø 5,0 - 5,1	 [N] : 387  [N] : 571	8,8	1,5 - 3,5	01.082211.48088		
			11,3	3,5 - 6,0	01.082211.48113		
			14,3	6,0 - 8,5	01.082211.48143		
6,0 [+0.01]	Ø 6,1 - 6,3	 [N] : 550  [N] : 960	10,0	1,5 - 4,0	01.082211.60100		
			13,0	3,0 - 6,0	01.092211.60130		
			16,0	6,0 - 9,0	01.082211.60160		
			19,0	9,0 - 12,0	01.082211.60190		

