

ERKEK SAPLAMALAR (TİP DD)

THREADED PADS TYPE DD

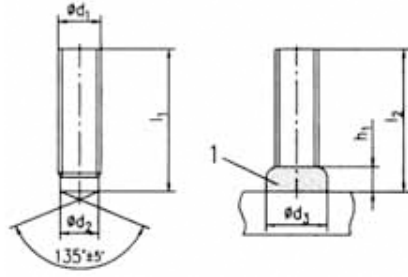
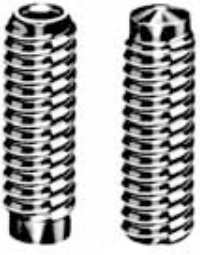

d_1	$l_2^{(2)}$ +0.6	d_2 ± 0.2	$d_3^{(1)}$ ± 0.08	$h_1^{(1)}$ ± 0.05
M6	15-40	5.35	8.5	3.5
M8	15-50	7.19	10	3.5
M10	20-55	9.03	12.5	4
M12	25-60	10.86	15.5	4.5
		M16	30-65	14.7

Malzemeler / Material : Steel (4.8) blank
1.4301/03 (A2-50)

Tavsiye Edilen Güç Üniteleri / Recommended power units :

ARC 500, ARC 800, ARC 1550, IT 1002, IT 2002, IT 3002, IT 90, IT 130

Tavsiye Edilen Kaynak Tabancaları / Recommended welding guns:

CA 08, A 12, A 16, A 22, A 25

Tavsiye Edilen Otomatik Kaynak Tabancaları Kafaları / Recommended welding guns heads:

PAH-1, KAH 412 KAH 412 LA